



**Price**

**£145,000**

**Leasehold**

2x  1x  1x 

**Laurel House, Trafalgar  
Road, Newport, Isle of  
Wight, PO30**

**OVER 60?**

Secure this property  
for up to **59% less!**

**Pittis**   
Helping you move forwards





## Main features

- Purpose built ground floor maisonette
- Allocated parking to the rear
- Modern fitted kitchen and upgraded shower room
- Convenient and central location
- Walking distance to town, schools and amenities

## Accommodation

### GROUND FLOOR

Entrance Hall

Lounge: 12'4 x 8'6 (3.76m x 2.59m)

Kitchen: 8'3 x 6'3 (2.52m x 1.91m)

Bedroom 1: 13'8 x 7'9 (4.17m x 2.36m)

Bedroom 2: 9'4 x 7'2 (2.85m x 2.19m)

Shower Room

### OUTSIDE

Allocated Parking

## Ground Floor

Approx. 45.3 sq. metres (487.5 sq. feet)

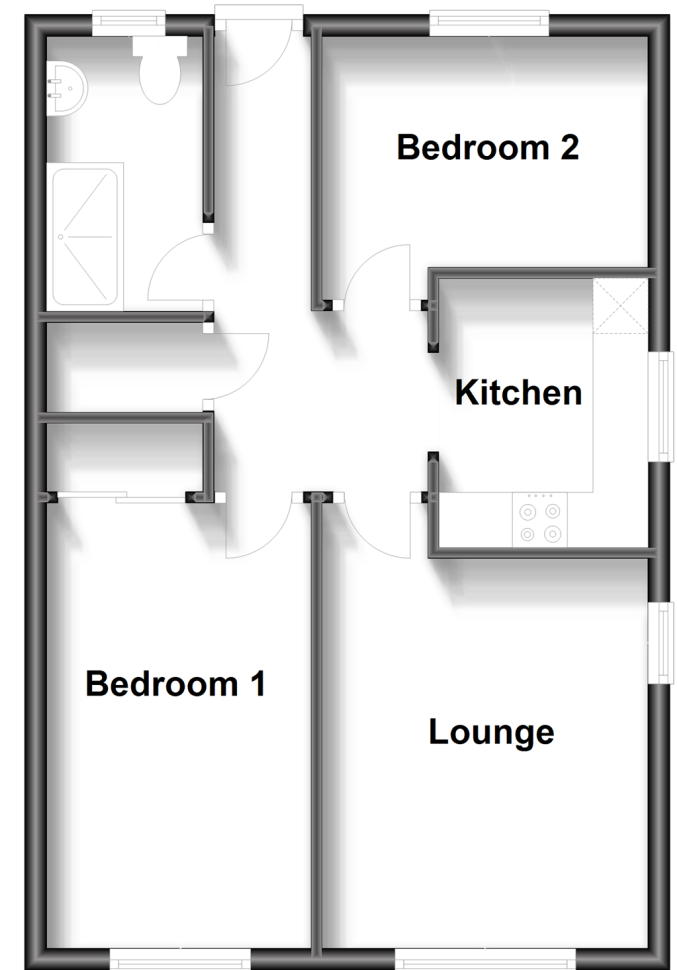

**Call Newport - 01983 528888 ■ [pittis.co.uk](http://pittis.co.uk)**

- Legal advice should be taken to verify fixtures/fittings, planning, alterations and/or lease details
- Appliances & services are untested, dimensions are approximate and floor plans are not to scale
- Through a Homewise Home For Life Plan people aged 60+ can secure this property for up to 59% less, by purchasing a Lifetime Lease.

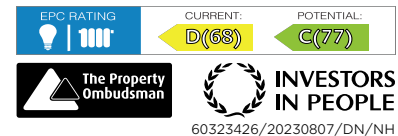

60323426/20230807/DN/NH