



Price
£275,000

Freehold

2x  1x  1x 

**Alexandra Road, Ryde,
Isle of Wight, PO33**

OVER 60?

Secure this property
for up to **59% less!**

Pittis 
Helping you move forwards



Main features

- **Spacious detached bungalow situated on a main bus route with garage & parking**
- **Some modernisation required, but benefits from a new bathroom**
- **Low maintenance gardens**
- **Ideally located for access to the town, supermarkets and transport links both on and off the island**

Accommodation

GROUND FLOOR

Hall

Bedroom 1: 13'10 x 12'10 (4.22m x 3.91m)

Bedroom 2: 10'11 x 9'11 (3.33m x 3.02m)

Bathroom: 7'0 x 6'10 (2.14m x 2.08m)

Kitchen: 11'5 x 9'4 (3.48m x 2.85m)

Dining Room: 9'10 x 8'7 (3.00m x 2.62m)

Lounge: 15'5 x 12'11 (4.70m x 3.94m)

OUTSIDE

Garage and Off Road Parking

Front and Rear Gardens

Ground Floor

Approx. 79.0 sq. metres (850.1 sq. feet)

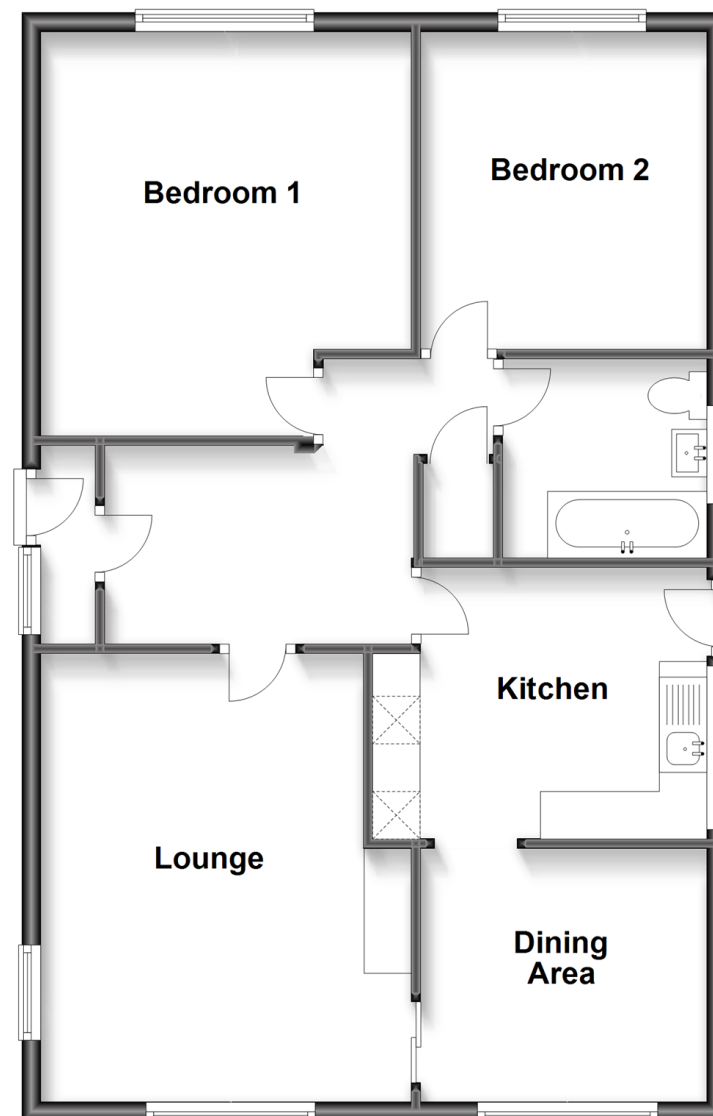

Call Ryde - 01983 564646 ■ pittis.co.uk

- Legal advice should be taken to verify fixtures/fittings, planning, alterations and/or lease details
- Appliances & services are untested, dimensions are approximate and floor plans are not to scale
- Through a Homewise Home For Life Plan people aged 60+ can secure this property for up to 59% less, by purchasing a Lifetime Lease.

