



OVER 60?

Secure this property
for up to **59% less!**

Price

£320,000

Freehold

2x  1x  1x 

**High Park Road, Ryde,
Isle of Wight, PO33**

Pittis 
Helping you move forwards



Main features

- Beautifully presented detached bungalow
- Sunny rear garden to enjoy in the summer months
- A short walk to local shops and bus stops
- The ideal home to move straight into and start your new life
- Large lounge / diner for entertaining

Accommodation

GROUND FLOOR

Entrance Hallway

Lounge: 12'0 up to bay x 11'5 (3.66m x 3.48m)

Dining Area: 12'0 up to bay x 11'5 (3.66m x 3.48m)

Bedroom 1: 11'4 x 9'6 (3.46m x 2.90m)

Bedroom 2: 10'11 x 9'3 (3.33m x 2.82m)

Kitchen: 12'9 x 7'1 (3.89m x 2.16m)

Conservatory: 12'6 x 10'10 (3.81m x 3.30m)

Utility Room: 9'11 x 2'11 (3.02m x 0.89m)

Separate Toilet

Shower Room

OUTSIDE

Front Garden

Driveway Parking

Rear Garden

Ground Floor
Approx. 90.2 sq. metres (970.7 sq. feet)

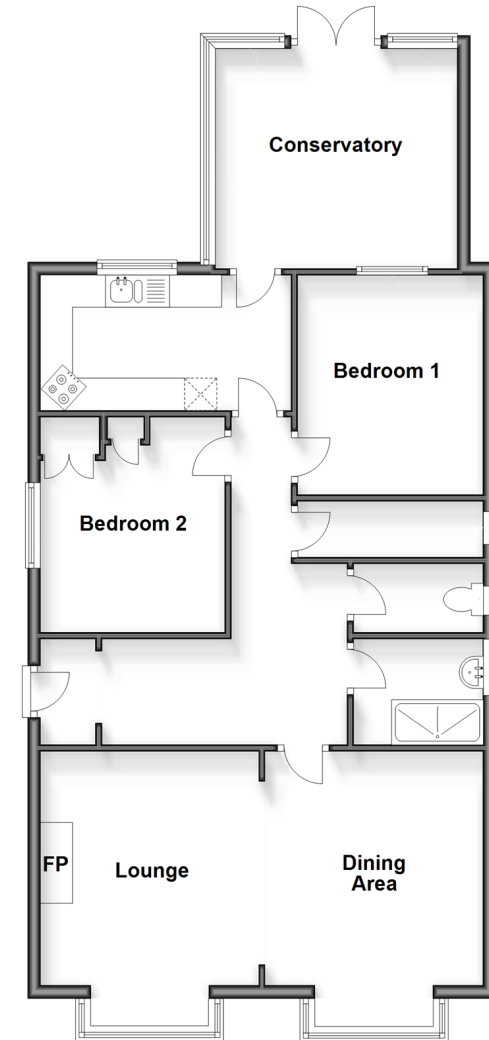

Call Ryde - 01983 564646 ■ pittis.co.uk

- Legal advice should be taken to verify fixtures/fittings, planning, alterations and/or lease details
- Appliances & services are untested, dimensions are approximate and floor plans are not to scale
- Through a Homewise Home For Life Plan people aged 60+ can secure this property for up to 59% less, by purchasing a Lifetime Lease.



60426295/20240409/RC/JW