

OVER 60?

Secure this property
for up to **59% less!**



Price
£265,000
Freehold

3x  1x  1x 

Coxs Green, Sandown, Isle of Wight, PO36

Pittis 
Helping you move forwards



Main features

- Detached bungalow overlooking open green area
- Good sized rear garden with recently installed fencing and side entrance
- Spacious lounge/dining area with double doors to garden
- Modern kitchen & bathroom
- Separate garage en bloc

Accommodation

GROUND FLOOR

Entrance Hallway

Lounge/Diner: 20'6 x 11'6 at widest point (6.25m x 3.51m)

Kitchen: 11'7 x 7'7 (3.53m x 2.31m)

Bedroom 1: 11'5 x 9'7 (3.48m x 2.92m)

Bedroom 2: 9'1 x 8'7 (2.77m x 2.62m)

Bedroom 3: 8'8 x 6'8 (2.64m x 2.03m)

Bathroom

OUTSIDE

Front & Rear Gardens

Garage en Bloc

Ground Floor

Approx. 68.6 sq. metres (738.2 sq. feet)

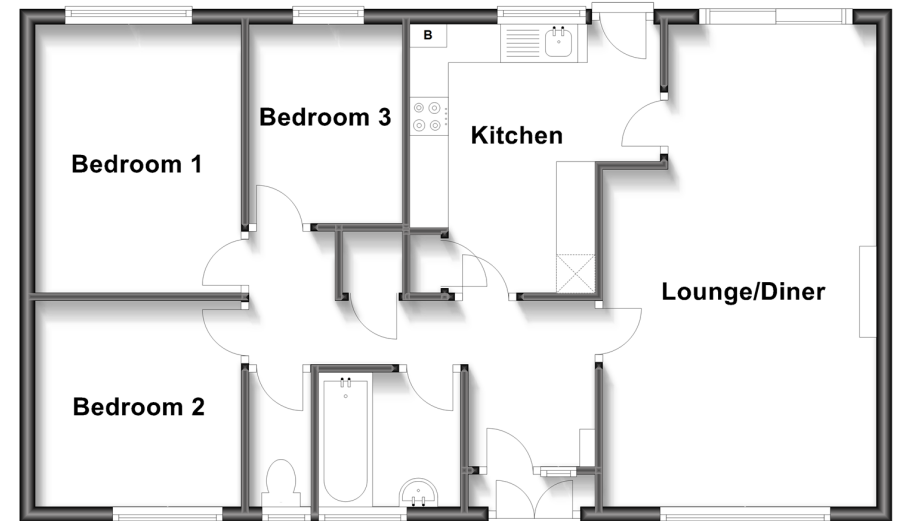

Call Sandown - 01983 407444 ■ pittis.co.uk

- Legal advice should be taken to verify fixtures/fittings, planning, alterations and/or lease details
- Through a Homewise Home For Life Plan people aged 60+ can secure this property for up to 59% less, by purchasing a Lifetime Lease.

- Appliances & services are untested, dimensions are approximate and floor plans are not to scale