



Price

£200,000

Leasehold

2x  1x  1x 

**Spring Gardens,
Shanklin, Isle of Wight,
PO37**

Pittis 
Helping you move forwards



Main features

- **Detached bungalow in a tucked away location**
- **Close to town centre with off road parking**
- **Lovely gardens which are easy to maintain**
- **In good order throughout with recently installed carpets**
- **Chain free sale viewing advised**

Accommodation

GROUND FLOOR

Entrance Hall

Lounge : 12'0 x 12'0 (3.66m x 3.66m)

Kitchen : 15'0 x 7'0 (4.58m x 2.14m)

Bedroom 1: 12'0 x 11'11 (3.66m x 3.63m)

Bedroom 2/Dining Room: 9'4 x 7'0 (2.85m x 2.14m)

Bathroom

OUTSIDE

Off Road Parking

Front & Side Gardens

Rear Garden

Ground Floor

Approx. 51.5 sq. metres (554.4 sq. feet)

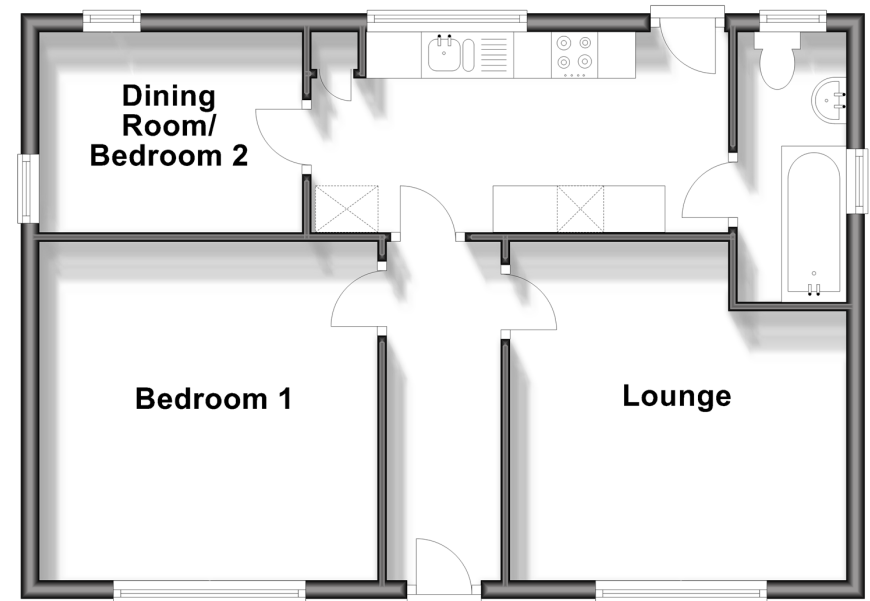

Call Shanklin - 01983 868777 ■ pittis.co.uk

■ Legal advice should be taken to verify fixtures/fittings, planning, alterations and/or lease details

■ Appliances & services are untested, dimensions are approximate and floor plans are not to scale



60618270/20231211/CS/CS