



OVER 60?

Secure this property
for up to **59% less!**

Price

£205,000

Leasehold

2x  1x  1x 

**Leighton Mount, Victoria
Avenue, Shanklin, Isle of
Wight, PO37**

Pittis 
Helping you move forwards

Ground Floor

Approx. 60.3 sq. metres (649.6 sq. feet)

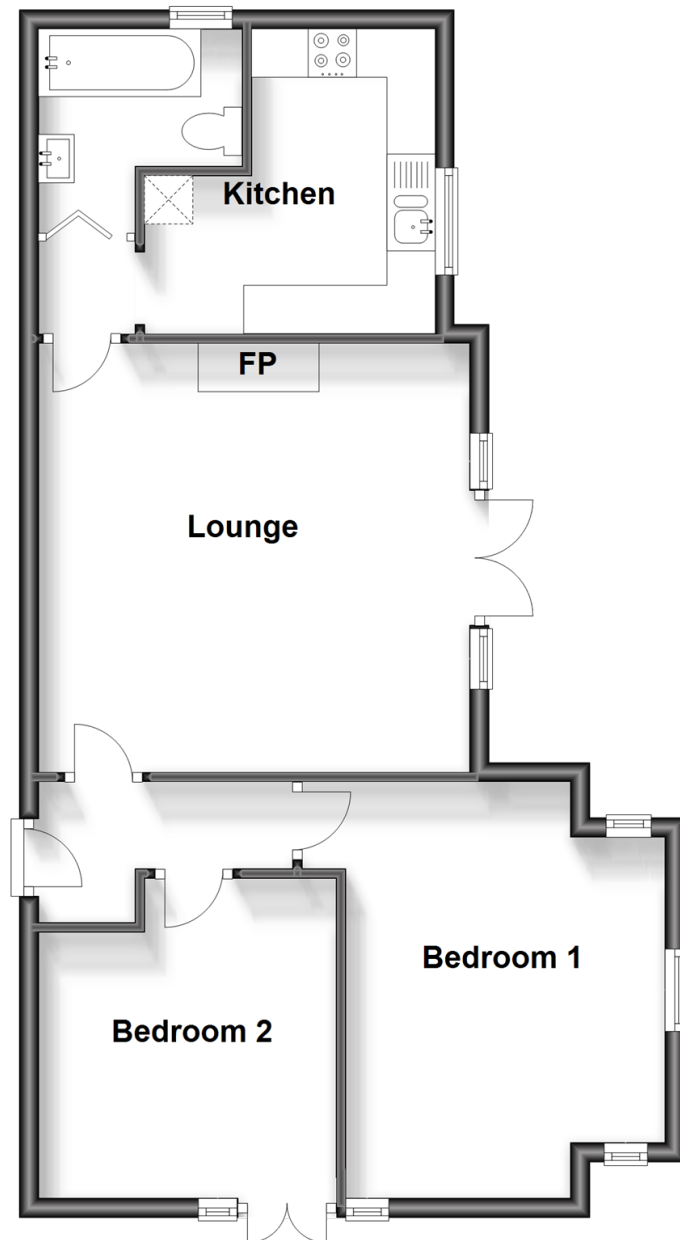

Accommodation

GROUND FLOOR

Entrance Hall

Lounge: 14'7 x 14'0 (4.45m x 4.27m)

Kitchen: 10'0 maximum x 9'10 maximum
(3.05m x 3.00m)

Bathroom

Bedroom 1: 14'2 x 9'1 (4.32m x 2.77m)

Bedroom 2: 11'0 x 10'1 (3.36m x 3.08m)

OUTSIDE

Communal Gardens

En Bloc Garage

Allocated Parking

Private Courtyard Garden



Main features

- Stunning ground floor apartment in this character period property
- Well managed and exceptionally maintained block, sold with a share of the freehold
- Private enclosed courtyard garden to the side
- Enbloc garage with parking forecourt, chain free sale, pets allowed
- Perfect retirement or second home



Nearest Schools

Shanklin C of E Primary School
Gatten & Lake Primary School
Broadlea Primary School
Newchurch Primary School
The Bay CE Secondary School



Transport Information

Local bus routes providing Islandwide connections



Address

Leighton Mount, Victoria Avenue, Shanklin, Isle of Wight, PO37



Directions

For directions to this property please contact us.

