



Price
£390,000

Freehold

3x  1x  1x 

**Stenbury View, Wroxall,
Ventnor, Isle of Wight,
PO38**

OVER 60?

Secure this property
for up to **59% less!**

Pittis 
Helping you move forwards

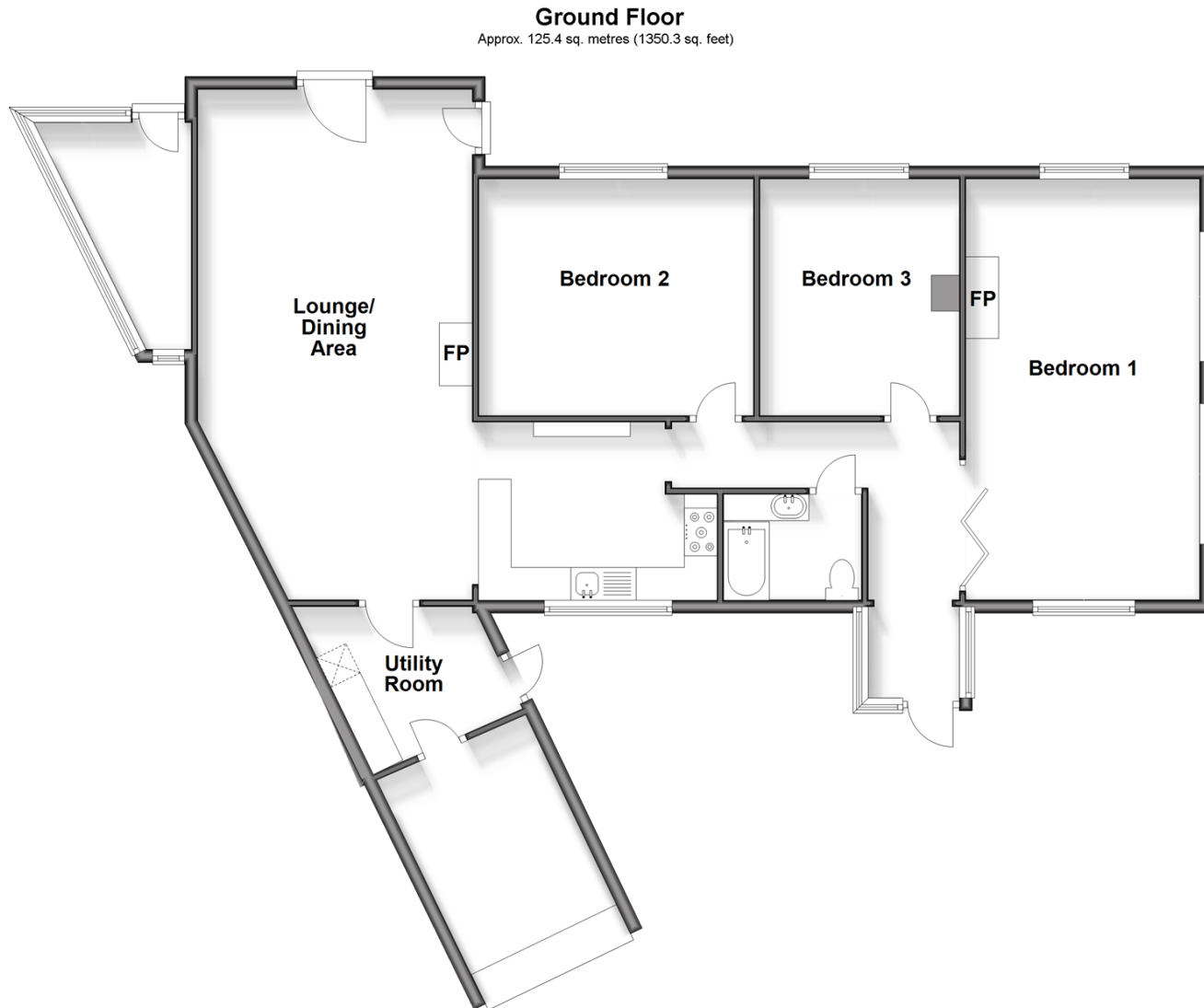

Accommodation

GROUND FLOOR

Entrance Hallway

Lounge/Dining Area: 26'8 x 14'7 (8.13m x 4.45m)

Kitchen: 10'10 x 9'3 (3.30m x 2.82m)

Utility Room

Bedroom 1: 21'1 x 11'7 (6.43m x 3.53m)

Bedroom 2: 12'1 x 9'9 (3.69m x 2.97m)

Bedroom 3: 13'9 x 12'9 (4.19m x 3.89m)

Bathroom

OUTSIDE

Garage & Driveway

Front & Rear Gardens



Main features

- Detached bungalow with stunning countryside views
- Wrap around gardens with pergola seating area
- Fantastic room sizes with log burning stove
- Garage (currently converted to storage) and driveway
- Ideal family home which has been upgraded in recent years



Nearest Schools

Primary Schools: Wroxall Primary School, 5 minutes walk

Secondary Schools: St Catherine's School 1.3 miles, Sandown High School 3.9 miles, Priory School 4.1 miles



Transport Information

Train Stations: Shanklin 3.9 miles, Lake 4.7 miles, Sandown 5.1 miles



Address

Stenbury View, Wroxall, Ventnor, Isle of Wight, PO38



Directions

For directions to this property please contact us.

